



## Galápagos aboard National Geographic Endeavour II

Zodiac to pristine beaches, kayak or stand-up paddleboard along volcanic shores, explore wildlife on land or under the sea. Experience the Galápagos aboard our elegant and nimble ship, well-equipped for up-close exploration. Perfect for couples, families, and solo travelers. Encounter abundant wildlife—blue-footed boobies, marine iguanas, Darwin’s finches, pink flamingos, giant tortoises and more. The wildlife of Galápagos is legendary for being without fear in the presence of humans.

 Year round	 <b>DURATION</b> 10 Days
 <b>SHIPS</b> <i>National Geographic Endeavour II</i>	
 <b>STARTS AT</b> Guayaquil, Ecuador	→  <b>ENDS AT</b> Guayaquil, Ecuador

### FOR RESERVATIONS CONTACT:

Safari Experts - Independent Safari Consultants  
 Phone: 435.649.4655  
 Email: [safari@safariexperts.com](mailto:safari@safariexperts.com)  
[www.safariexperts.com](http://www.safariexperts.com)  
 P.O. Box 680098 Park City, UT 84068

## Highlights

- ★ Benefit from our 50+ years of experience in Galápagos and deep knowledge of the archipelago to see all you came for and more
- ★ Adventure by kayak, paddleboard, glass-bottom boat, and Zodiac
- ★ Walk among wildlife unfazed by your presence: lounge on beaches with sea lions, marvel at huge colonies of marine iguanas, and see nesting seabirds
- ★ Snorkel with sea lions, turtles, and abundant fish in the protected waters of the Galápagos Marine Reserve



## Day by day

### DAY 1

#### Guayaquil, Ecuador

Upon arrival in Guayaquil, transfer to the Hotel Oro Verde Guayaquil, a convenient locally-owned hotel, for an overnight stay. Most international flights arrive in the late evening. If you wish, you may instead fly into Quito, Ecuador's historic capital city in the highlands, take a pre-voyage extension to Mashpi Reserve in the tropical Andes, or arrive a day early in Guayaquil to rest and relax. Or opt for the full-day excursion from Guayaquil to Hacienda La Danesa.

**Arrival Time:** Anytime.

**Arrival City:** Guayaquil or Quito, Ecuador

### DAY 2

#### Guayaquil / Galápagos Islands

In the morning we will fly to the Galápagos and embark the *National Geographic Endeavour II*. After lunch, our journey begins as we explore the islands and their remarkable wildlife.

**Meals included:** breakfast, lunch, dinner

### DAYS 3-8

#### Galápagos Islands

Below are a selection of islands we may visit during our expedition. Itineraries are subject to Galápagos National Park regulations.

##### **North Seymour:**

Follow coastal trails past playful Galápagos sea lions on this wildlife-rich central island. Continue inland through a silvery forest of endemic palo santo trees, where frigatebirds nest, blue-footed boobies dance, and where we may also encounter prehistoric-looking land iguanas feeding on cactus.

##### **Isabela:**

Cross the Equator at Volcán Ecuador, northernmost of Isabela's six great shield volcanoes. Keep an eye out for whales and dolphins, sea turtles, and the elusive ocean sunfish. Over two days, land in the footsteps of Darwin and Melville, and look for wildlife along the wildly eroded volcanic shore.

##### **Fernandina:**

One of the most active oceanic volcanoes in the world, Fernandina is the youngest and most pristine island in Galápagos – and home to the strange flightless cormorant, Galápagos penguins, and the largest marine iguanas. Hikes ashore lead across impressive recent lava flows.

##### **Española:**

See swallow-tailed gulls, Española mockingbirds, Nazca boobies and, seasonally, the world's only population of waved albatross at this bird paradise, also home to vividly colored marine iguanas. Watch sea lions on the white sand beach, and snorkel offshore at Gardner Bay.

##### **Floreana:**

Follow a trail past a rose pink-tinted lagoon sometimes frequented by flamingos. Snorkel among sea lions and abundant fish, or cruise along Champion Islet by Zodiac. Visit the historic mail barrel at Post Office Bay.

##### **Santa Cruz:**

Visit Puerto Ayora, the largest town and headquarters of both the Galápagos National Park and Charles Darwin Research Station. See the monument to Lonesome George, and tour the giant tortoise breeding corrals. Witness the giant tortoises roaming in the wild in the lush, green highlands.

##### **Bartolomé:**

Climb the steps to the summit of this 300-foot volcanic wonderland for stunning views. Explore,

swim, and snorkel from the beach. Catch a glimpse of Galápagos penguins, one of the world's rarest.

**Santiago:**

Explore tide pools and look for fur seals sheltered in quiet grottos of black basalt. Swim, snorkel, kayak, and paddleboard along Santiago's spectacular coast, and explore an enchanting coastal forest where Charles Darwin once walked.

**Genovesa:**

Sail across the Equator to the remote northern realm of the Galápagos into this flooded caldera, home to over one million seabirds. Visit Prince Philip's Steps at the top of the island. Highlights along the trail are many, from Nazca, red- and blue-footed boobies and frigates, to gulls, owls, fur seals, hammerhead sharks, turtles, and manta rays.

**San Cristobal:**

Search for red-footed boobies and the endemic mockingbird and lava lizard – found only on this easternmost island. Walk along the powdery white sand at a gorgeous beach fronted by iconic Kicker Rock. Explore Baquerizo Moreno, where sea lions thrive in the middle of town.

Meals included: breakfast, lunch, dinner

## ◇ DAY 9

## Galápagos Islands / Disembark / Guayaquil

Disembark this morning for a return flight to Guayaquil, where we transfer to Hotel Oro Verde Guayaquil. The late afternoon and evening are free to explore the city. You may be able to take advantage of overnight flights. Ask your expedition specialist about Peru, Quito, and other post-voyage options.

Meals included: breakfast

## ■ DAY 10

## Guayaquil

After breakfast, leave Hotel Oro Verde in Guayaquil for the airport and flights home, unless an extension has been arranged.

**Departure Time:** Anytime on day 10, or anytime after 7:00 p.m. local time on day 9.

**Departure City:** Guayaquil or Quito

Meals included: breakfast



## ***National Geographic Endeavour II***

---

**Guests**

96

**Cabins**

52

---

**Our latest and most family-friendly ship, the *National Geographic Endeavour II* is exceptionally nimble and maneuverable.**

Born in the cold waters of Patagonia, *National Geographic Endeavour II* was built for heavy seas. Now, permanently stationed in Galápagos, she comfortably sails the Equator.

A floor-to-ceiling rebuild when she repositioned to the tropics meant she could be crafted to perfectly accommodate the Lindblad style of travel. Where she previously carried 136 passengers, she now accommodates just 96 guests in 52 thoughtfully appointed cabins. She is exceptionally nimble and maneuverable,

with a shallow draft to get up close, great viewing from all public spaces, an expansive open-air observation deck, large windows in cabins and suites, and state-of-the-art tools for exploration including a glass-bottom boat, underwater cameras, video microscope, plus kayaks and stand-up paddleboards.

She replaced the beloved *National Geographic Endeavour*, which donated much of her artwork and her great spirit of camaraderie. Guests have described being aboard *National Geographic Endeavour II* as feeling like a cross between a grand floating hotel and scientific research vessel. She is beyond comfortable, and welcoming to solos, groups, and kids of all ages, and equipped for the up-close and personal explorations that makes Galápagos the trip of a lifetime.

Welcome aboard. From your first sight of the art to the left of the reception desk (part of the pioneering polar art exhibit, *Change*, installed onboard) to the sleek lines and calming neutrals, you can feel the rigors of travel drop away. Ahead: only supreme comfort and the exhilaration of discovery.



# Deck Plans

## Observation Deck

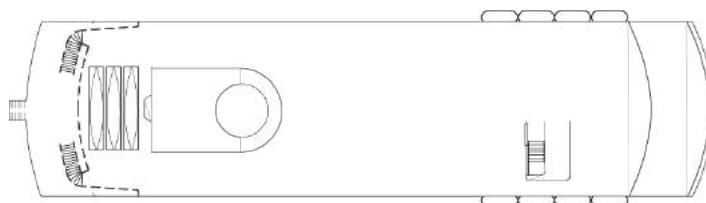

## Bridge Deck

- Category 4
- Suite B
- Suite C

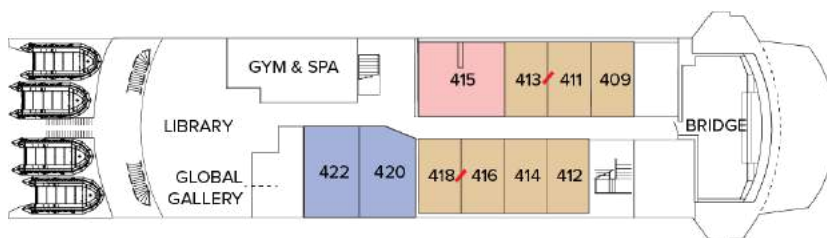

## Lounge Deck

- Category 3
- Suite A
- Category 3 Solo



## Upper Deck

- Category 1
- Category 2
- Category 2 Solo

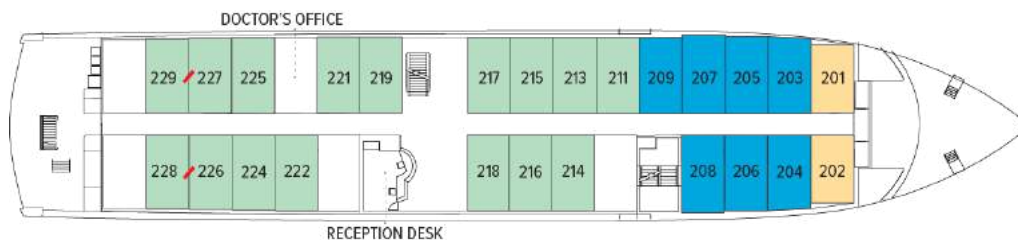

## Main Deck

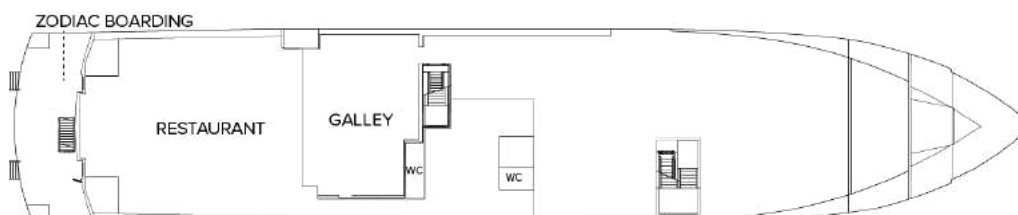

## Ship amenities

### Public Areas

Forward lounge and bar accommodating all guests for presentations and gatherings, restaurant, large library with Mac kiosks, open-air observation deck, underwater gear area and dual Zodiac boarding platform, and “open bridge,” where guests can meet the Captain and officers and learn about navigation.

### Meals

Meals are served in the dining room or sometimes outdoors, in a single, unassigned seating with a sociable, informal atmosphere with Ecuadorian flair.

### Cabins

52 outside cabins. All feature ocean views, private facilities, climate controls, and hair dryers, plus Ethernet, Wi-Fi connections and USB ports for mobile devices. Choose from suites on two decks, plus connecting cabins and triples are available for families and friends.

### Expedition Equipment

Zodiacs to get to shore quickly, glass-bottom boat, kayaks and paddleboards for personal explorations, snorkel gear and wetsuits for both adults and children, video microscope and underwater video camera.

### Special Features

A full-time doctor, undersea specialist, Lindblad-National Geographic certified photo instructor and video chronicler.

### Wellness

A fitness center, *LEXspa* treatment room, exercise room and wellness specialists.



### Self-Disinfecting Ships

Act Clean Coat™ is a light-activated, self-disinfecting cleaning process that continuously breaks down viruses, bacteria, mold, and airborne allergens across all ship surfaces. This non-toxic, chemical-free system also helps us save over one million gallons of water each year in our cleaning procedures.